

ID-Nr. 40590-901
Model GAP.140.120.EX

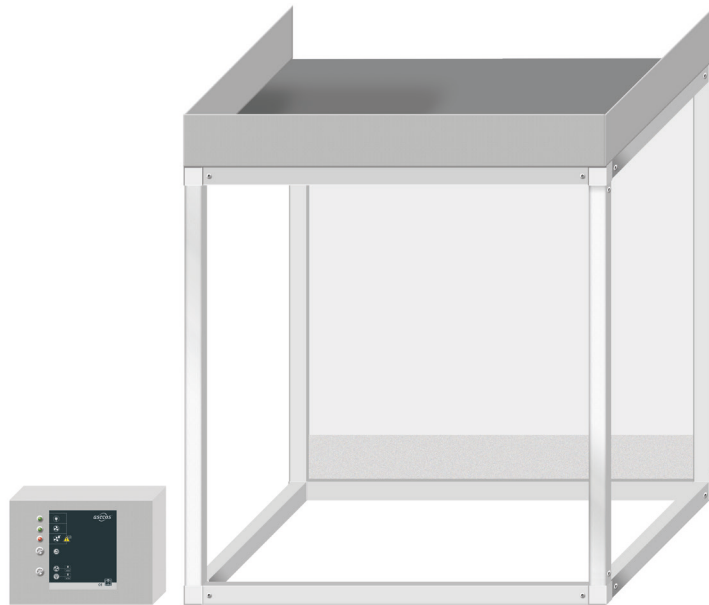

Function / construction:

- Required occupational exposure limits are maintained
- Testing of the air equipment according to EN 14175 Part 3 (5.4.4)
- Maximum user safety
- Robust construction made of chemically resistant, anodised aluminium profiles
- Transparent side panes made from 5 mm (toughened safety glass)
- Highly effective capturing of hazardous materials inside the work station through special fresh air curtain technology
- Prepared for connection to the on-site exhaust air system
- Electrical equipment approved in accordance with 2014/34/
EU For regulation-compliant usage in potentially explosive areas Zone 1:
- Workplace lighting LED: IBExU 16 ATEX 1008, Zone 1
Application area II 2 G Ex eb mb op is q IIC T4 Gb
- Supply air fan: PTB 03 ATEX 3004, Zone 1
Application area II 2 G, c T4

- Switch amplifier: PTB 00 ATEX 2081
Application area II (1) GD EEx ia II c
- Differential pressure switch: BSV 06 ATEX E141 x
Application area II 2 G Ex ia II B T4
- Motor overload switch: PTB 01 ATEX 3307
Application area II (2) GD

Standard equipment

- Working surface (stainless steel brush-finished)
- Support frame for standing activities (powder-coated steel)
- Earthing link mounted in the profile

Technical data

External dimensions (mm)		Work height (mm)	
Height (external)	1400	Work height standing	900
Height with support frame for standing work	2265		
Width (external)	1200	Weight (kg)	
Depth (external)	750	Weight	146.20 kg
Internal dimensions (mm)		Further information	
Clear height	1110	Amount of air ducts	1 piece
Width (internal)	1165	Nominal volume flow	720 m³/h
Depth (internal)	650	Differential pressure per air duct	103 Pa
		Noise level (approx.)	55.0 dB
Usable work surface (mm)		Frequency	50 Hz
Width usable work surface	1090	Power consump. in operation	145 W
Depth usable work surface	640	Max. current consumption	1 A
Max. charge of the working surface	3000 N/m²	Nominal voltage	230 V

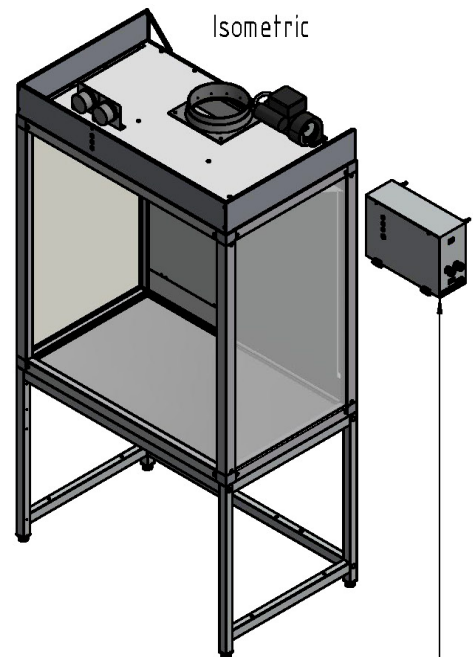
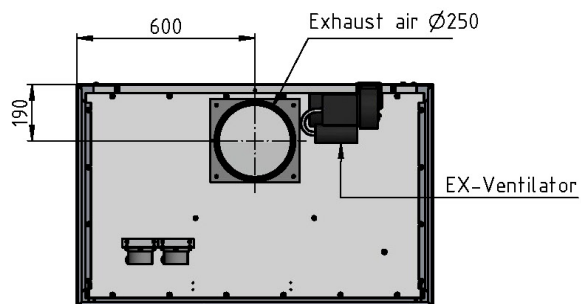
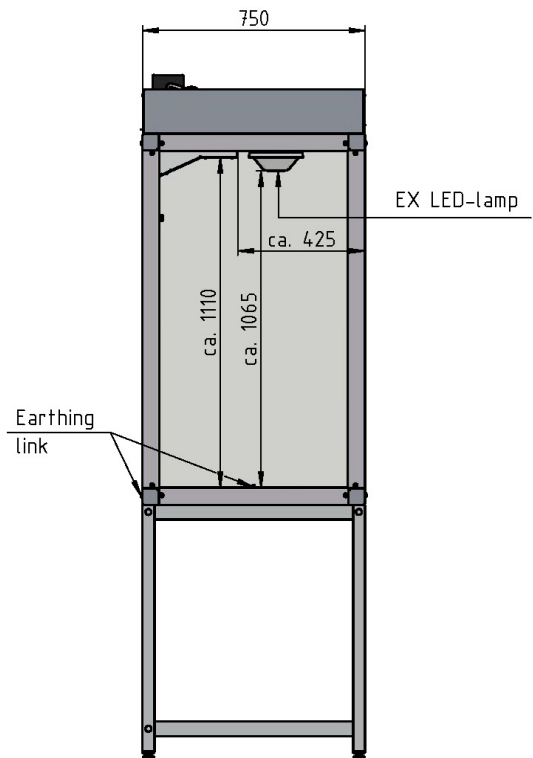
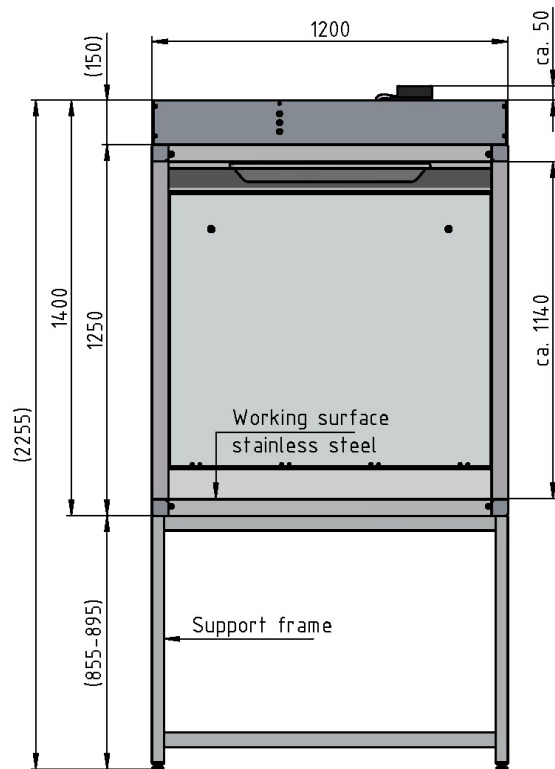

Monitoring module for mounting
outside of the EX zone incl.
potential-free contact